

**IMPORTANT: You must read the installation and owner's manual provided with the griddle.**

**INSTALLER:** Leave these instructions with consumer. **CONSUMER:** Retain for future reference.

## 1-Safety

**CAUTION: WHEN INSTALLING AND OPERATING THIS APPLIANCE, ALL INSTRUCTIONS AND WARNINGS IN YOUR OWNER'S MANUAL MUST BE OBSERVED. FAILURE TO DO SO MAY RESULT IN A FIRE OR EXPLOSION CAUSING PROPERTY DAMAGE, BODILY INJURY, OR DEATH.**

This griddle must be installed in accordance with local codes and ordinances, or, in the absence of local codes, with either the latest National Fuel Gas Code (ANSI Z223.1/NFPA 54), and Natural Gas and Propane Storage and Handling Installation Code (CSA-B149.1).

This appliance and its individual shutoff valves must be disconnected from the gas-supply piping system when testing the system at pressures in excess of ½ psig. This appliance must be isolated from the gas-supply piping system by closing its dedicated manual shutoff valve during any pressure testing of the gas-supply system at pressures up to and including ½ psig.

**This unit is designed for outdoor use only. DO NOT use this unit inside a building, garage, or enclosed area (see paragraph below). DO NOT use this unit in or on a recreational vehicle or boat.**

A minimum 5 foot clearance is required between the cooking surface and the overhead construction. When installed under combustible overhead construction, the area above the cooking surface of the griddle **must** be covered with an exhaust hood. The exhaust hood provides the protection for the combustible overhead construction. **DO NOT use this appliance under unprotected combustible overhead construction.** When installed under overhead non-combustible construction, an exhaust hood is highly recommended. **When using an exhaust hood:** the area above the cooking surface of the griddle must be covered with a hood larger than the cooking area of the griddle, and with a minimum of 1200 CFM (cubic feet per minute) for proper outdoor application.

**Installation must be performed by a qualified professional service technician.**

## 2-Unpacking

Carefully unpack the unit, removing all packing material and protective film (including the clear film on the drip tray). The griddle top will need to be removed to access all packaged contents. Refer to the REMOVE PACKAGED CONTENTS AND GRIDDLE TOP section of your griddle owner's manual. Verify that all parts have arrived undamaged by consulting the parts list in the owner's manual. Remove foam packed hardware from oven area. (See Fig. 2-1.)

Consult the parts list in the owner's manual. If any parts are missing or damaged, immediately contact the Fire Magic dealer before beginning installation.

**Important: The 2 shipping screws must be removed prior to removing the unit from the wooden pallet.** The screw located on the bottom left side of the unit is accessed by opening the door. The screw located on the bottom right side of the unit is accessed by removing the lower drawer.

To remove the drawer; pull it completely out. Release the drawer from the drawer slides by pressing the black lever down on the right side, and up on the left side.

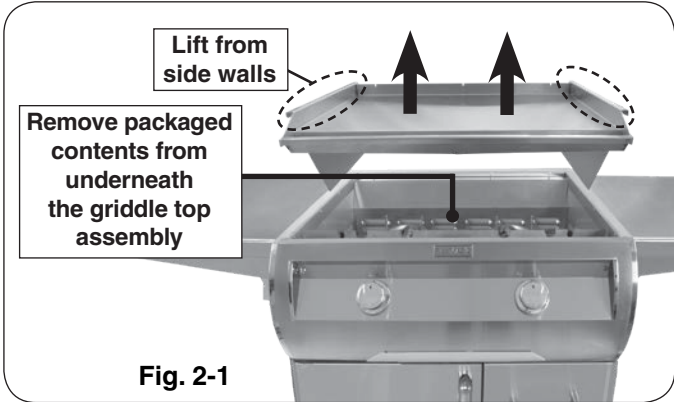

## 3-Installation

### Location

Locate the unit on a flat level surface. Refer to the INSTALLATION REQUIREMENTS section of your griddle owner's manual for complete details.

**CAUTION: Wind blowing into or across the rear vent (Fig. 3-2) can cause poor performance and/or dangerous overheating. Orient the griddle so that the prevailing wind blows toward the front of the griddle (Fig. 3-1).**

**CAUTION:** To prevent dangerous overheating, the rear of the unit must have a minimum clearance of 4" from any non-combustible wall.



### Connect Gas supply

These quick start instructions assume a propane cylinder configured unit. **See main instructions for natural gas or household propane configured units.**

Place approved propane 20 lb cylinder in tank tray and lock holder in position (Fig. 3-3).

Connect coupler hose and regulator supplied with unit to propane cylinder (Fig. 3-4).

Turn all burner control knobs to the **OFF** position. Open the main cylinder valve. Then carefully check all gas connections for leaks with a brush and half-soap/half-water solution before lighting. **NEVER USE A MATCH OR OPEN FLAME TO TEST FOR LEAKS.**

Proper airflow (front-to-back) must be maintained as shown in Fig. 3-5.

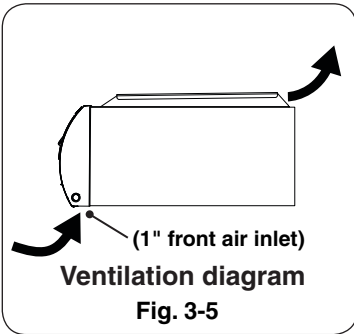
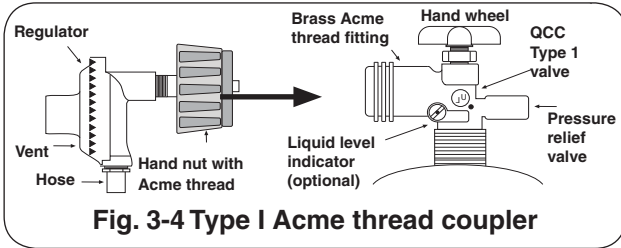
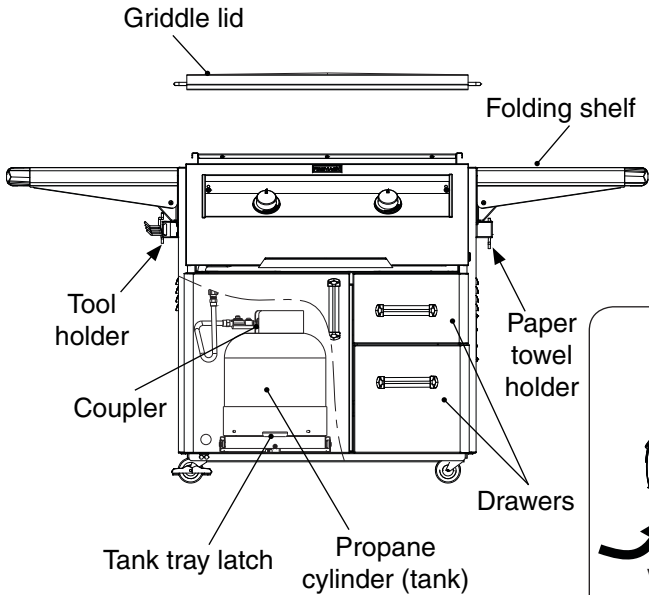

**To connect the regulator/hose assembly to the propane-gas cylinder valve fitting:** Press the hand nut on the regulator over the Acme thread fitting on the cylinder valve. Turn the hand nut clockwise to engage the threads and tighten until snug.

## 4-Griddle Setup

### Parts Placement Checklist

Install the following items according to their position and orientation in Fig. 4-1:

Griddle top assembly, rear exhaust plate, drip collector trough, drip tray, and griddle lid.

Leave pre-installed burners in place to maintain proper alignment.

#### Griddle Top assembly

The griddle top must be lifted out to remove all packaged contents, slide unit into enclosure easily, and perform a lighting test. Then, reinstall the griddle top. See the main griddle owner's manual for complete details.

#### Rear Exhaust Plate

Assemble the provided bolts and nuts (loosely) to the three holes on the rear exhaust plate. Align the exhaust plate with the three cutouts on the griddle rear wall and fasten.

#### Drip Collector Trough

Place the left piece inside the griddle drip reservoir and completely slide it to the left side. Place the right piece and ensure it overlaps the left tray.

#### Drip Tray

Carefully align the drip tray to the opening found on the bottom front of the control panel and fully insert.

#### Griddle Lid

Using the handles, carefully place the griddle lid over the cooking area. Remove before using griddle.

**IMPORTANT:** See your griddle owner's manual for complete installation details.

Replacement parts can be ordered from your local Fire Magic dealer.

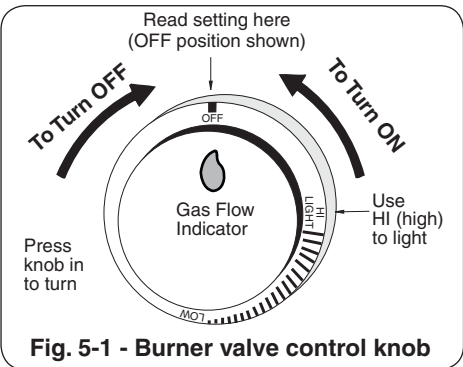
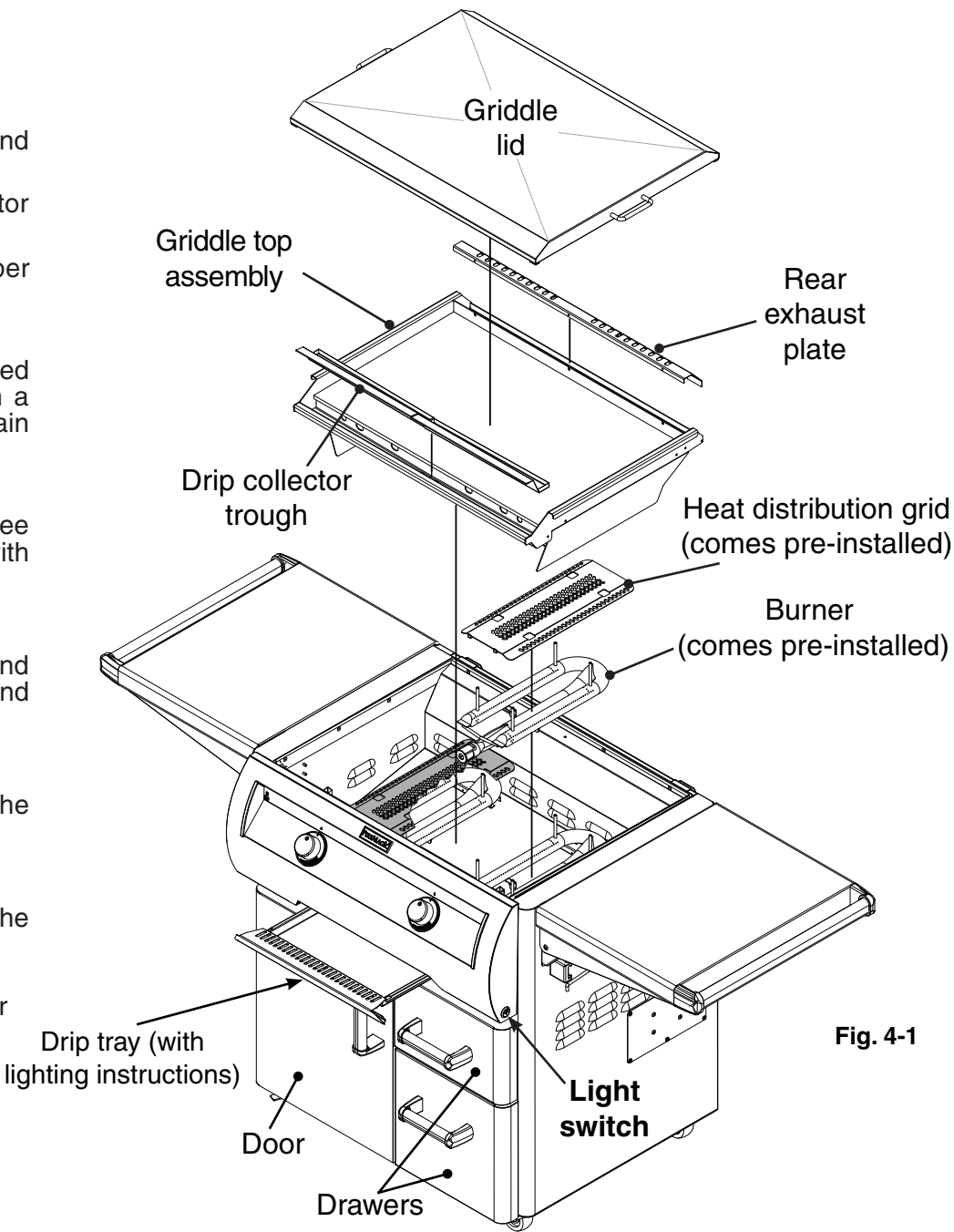

For your convenience and safety; when the control knob is turned to the ON position, the gas flow indicator will change from blue to red. (Red indicates gas flow.) See Fig. 5-1.

**WHEN OPERATING THIS GAS APPLIANCE, ALL INSTRUCTIONS AND WARNINGS MUST BE OBSERVED. FAILURE TO DO SO MAY RESULT IN A FIRE OR EXPLOSION CAUSING PROPERTY DAMAGE, BODILY INJURY, OR DEATH.**

#### LIGHT SWITCH

The light switch (Fig. 5-2) is push button operated, and is located on the right side of the control panel. It controls the power to the lighted knobs.

## 5-Test

**Note:** This unit must be connected to 120VAC power for electronic lighting.

1. Remove the griddle lid.
2. Turn all gas control knob(s) to their **OFF** position(s).
3. Turn on the gas at its source.

**Note:** DO NOT turn on more than one valve at a time for either electronic or manual lighting.

4. Depress the desired control knob **for 5 seconds**. Ensure the igniter is glowing (inside of lighting tube), then, while pressing turn it counterclockwise to the **HI LIGHT** position. Once the burner lights, release the knob.

**IMPORTANT:** Inspect the burner flames by looking through the burner flame viewing cutouts located above the drip collector trough (see Fig 5-2). Adjust viewing position if needed to ensure flame presence.

**CAUTION:** If a burner does not light within five (5) *seconds* of turning on the control knob, depress the knob and turn it to the **OFF** position. **WAIT FIVE (5) MINUTES** before repeating step 4. If you smell gas, follow the instructions on the cover of the griddle owner's manual. If the burners still do not light after several attempts, refer to the griddle owner's manual for manual lighting.

5. Repeat step 4 for the second burner.

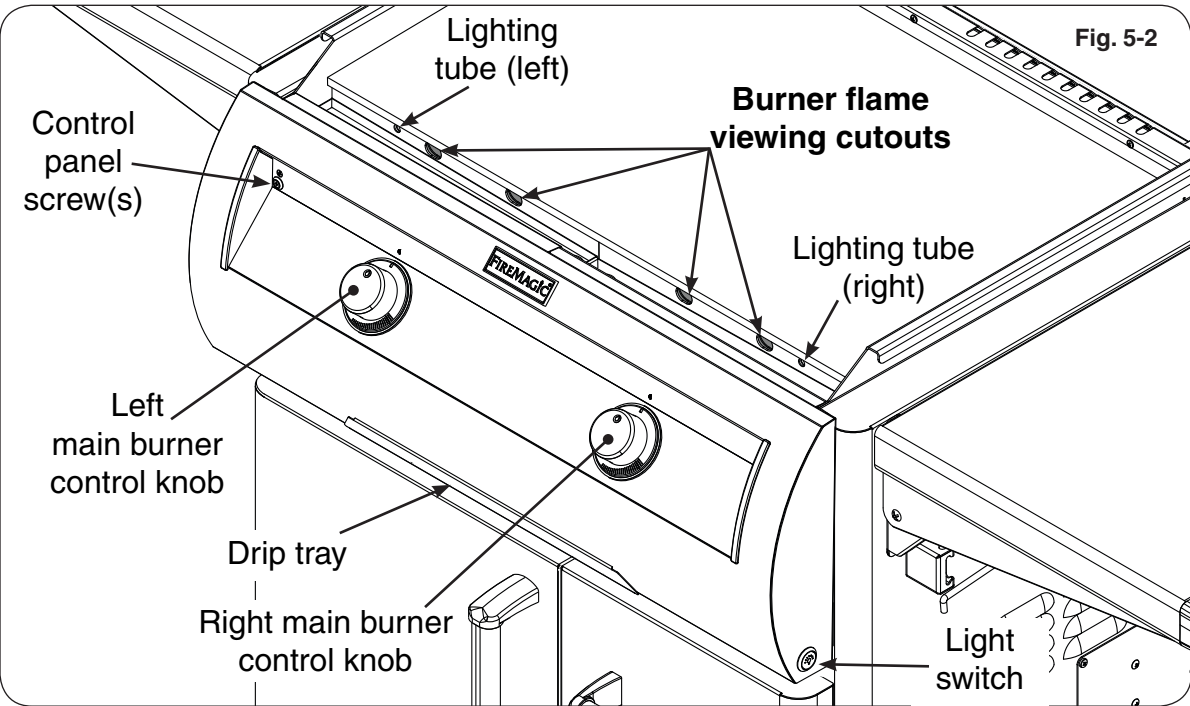

## 6-Propane and Natural Gas Safety

**IMPORTANT: READ AND FOLLOW ALL WARNINGS PROVIDED WITH THE PROPANE-GAS CYLINDER.**

**READ ALL SAFETY INSTRUCTIONS AND WARNINGS REGARDING THE USE OF PROPANE GAS FOUND IN YOUR OWNER'S MANUAL. FOR NATURAL GAS READ ALL SAFETY INSTRUCTIONS AND WARNINGS FOUND IN YOUR OWNER'S MANUAL.**

## 7-Routine Maintenance

Your griddle must be serviced and maintained properly to ensure optimal performance, appearance, and **safety**. Clean your griddle **before and after each use**. Additionally, a deep clean of the entire griddle and all its components be performed **twice a year**. See owner's manual for details.