



GFRF ISLAND (L-SHAPED MODELS)

Model #s: IL660-FO(R,K,D)-116BA
IL660-SP(R,K,D)-116BA

ASSEMBLY INSTRUCTIONS AND OWNER'S MANUAL

INSTALLER: Leave these instructions with consumer.
CONSUMER: Retain for future reference.

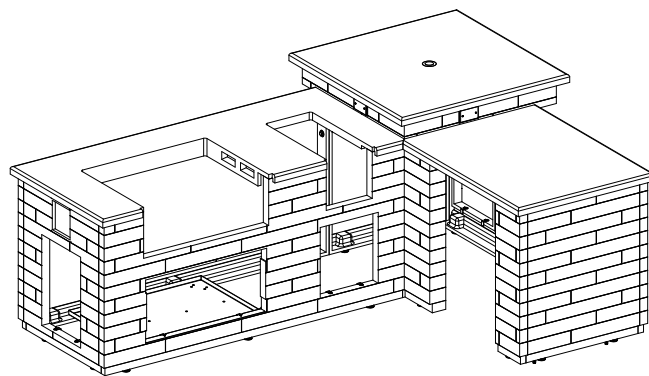

IL660-FOR
model shown

IMPORTANT: READ THESE INSTRUCTIONS CAREFULLY BEFORE STARTING INSTALLATION OR USE.

- Only Fire Magic grills/griddles/pizza ovens and accessories can be used with this island.
- Fire Magic grill/griddle/pizza oven and accessories are not included. Contact your dealer for ordering information.
- When installing an L.P. cylinder within this island, it must be installed with a Fire Magic Door w/ Tank Tray and Louvers:
Model #s 53820SC(H)-T(L,R), 33820-TS(L,R), 23920-1T-S
- **Follow all instructions included with the grill/griddle/pizza oven and accessories to be installed into this island.**
- This island design provides all necessary ventilation.

SPECIFICATIONS AND DIMENSIONS

Description	Dimension
Height	42 1/2"
Width	116"
Depth	84"

Table 1 - Overall Island Dimensions

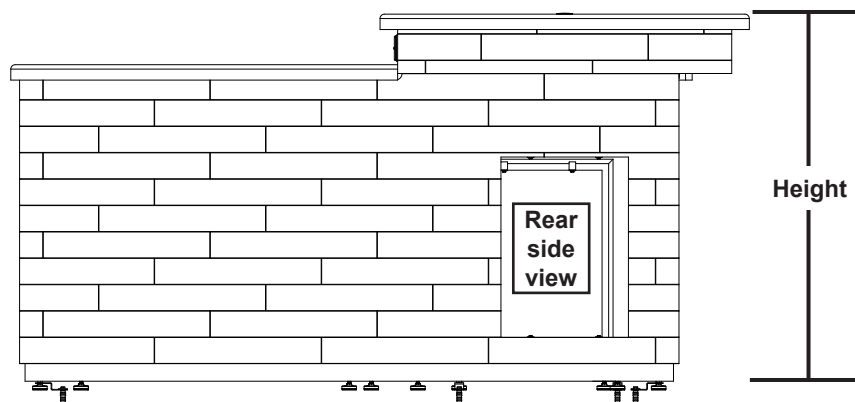
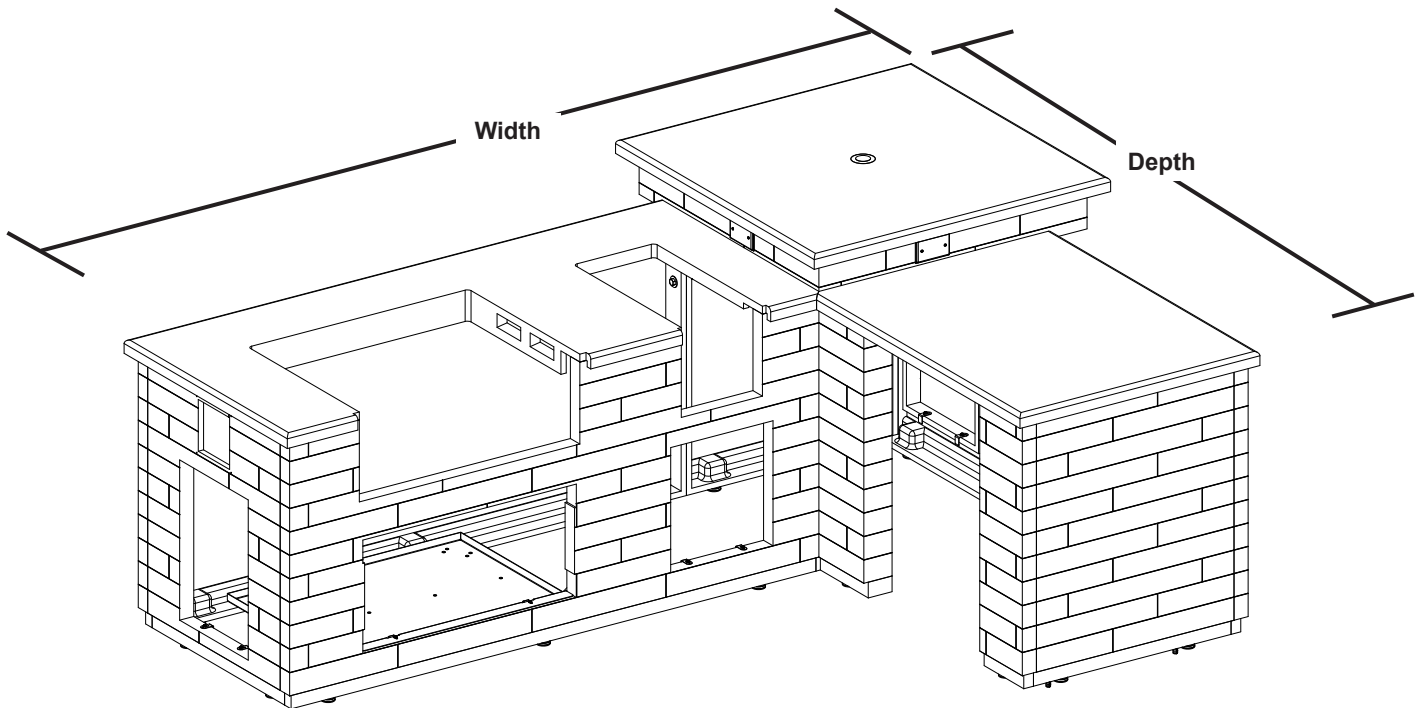

**IL660-FOR
model shown**

SPECIFICATIONS AND DIMENSIONS (Cont.)

Only Fire Magic grills/griddles/pizza ovens and accessories can be used with this island. **Below is a list of the options available for each island model. Contact your local dealer for ordering information.**

Item		Option(s)
1.	Grill/Griddle/Pizza Oven	E660i, A660i, 5600
2.	Double Side Burner	32815(H), 32817
3A.	Pantry Door/Drawer	54018S
3B.	Refrigerator	3598-D(L,R)
3C.	Kegerator	3594-D(L,R)
4.	End Access Door	53820(H)SC-T(L,R), 53920(H)SC-(L,R), 33820-TS(L,R), 33920-S(L,R), 33920-1-S(L,R), 23920-1T-S, 23920-1-S, 23920-S,
5.	Under Grill Double Access Doors	53934SC
6.	Rear Access Door *	53920(H)SC-(L,R), 23920
7.	Double Enclosed Drawers	53802(H)SC, 33802
8.	Stainless Steel Gas Timer Box	5521-11T, 5521-13T

* not shown

Table 2 - Island Options

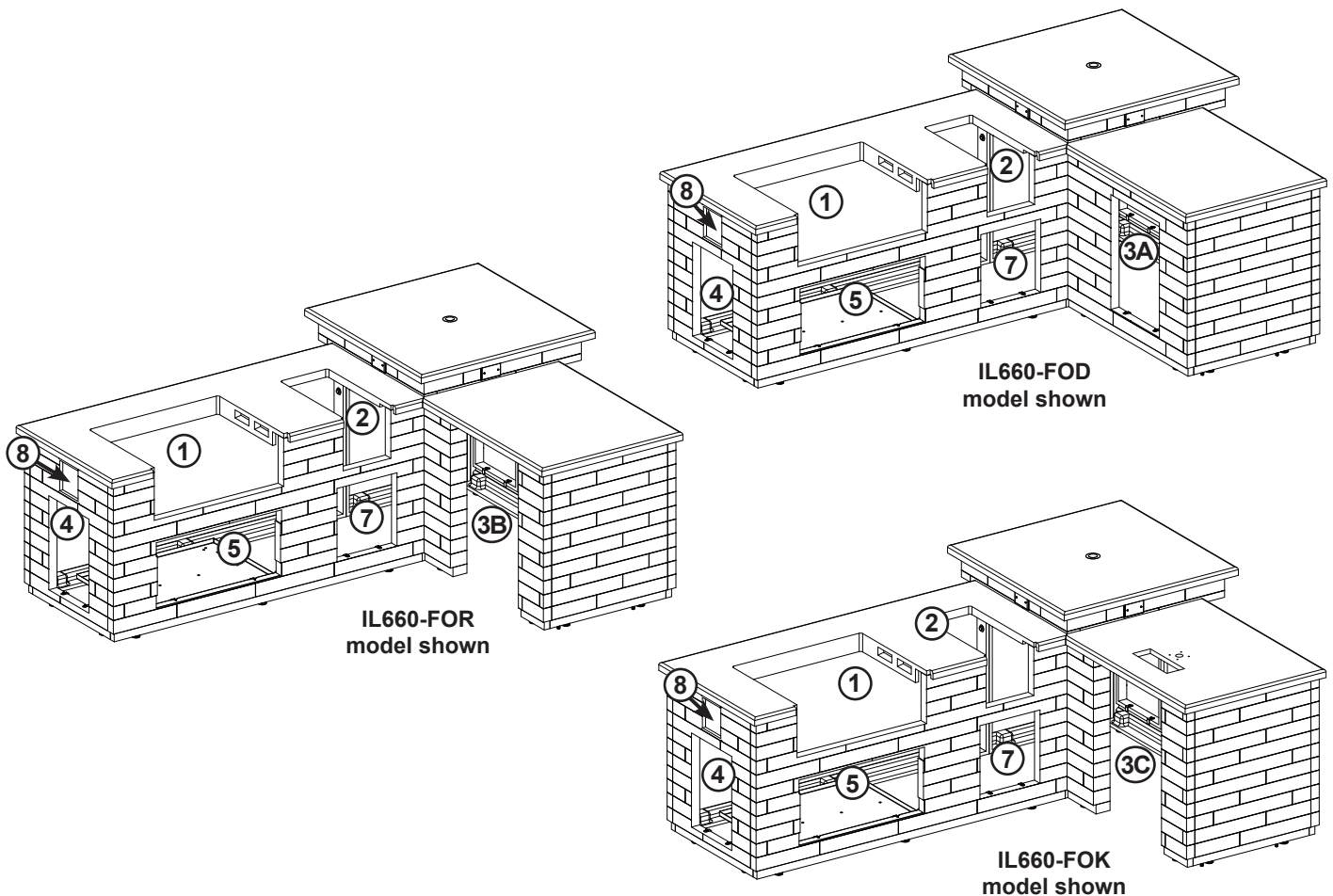

PARTS LIST

		IL660-(FO,SP)D
Item	Description	Qty.
1.	Side wall (A)	1
2.	Rear wall (B)	1
3.	Front wall (C)	1
4.	Rear wall (D)	1
5.	Side wall (E)	1
6.	Front wall (F)	1
7.	Side wall (G)	1
8.	Top piece (H)	1
9.	Countertop (3 pieces)	1
10.	Floor pan	1
11.	Power supply box bracket (w/ Phillips screws)	1
12.	Outlet bracket *	1
13.	Duplex outlet box assy. *	3
14.	Door bracket (w/ hex screw)	20
15.	Leveler bolts	19
16.	Floor mounting brackets (w/ hardware)	5
17.	Hardware kit A * †	10
18.	Hardware kit B * ‡	6
19.	Timer box screws *	4

* not shown
† each kit contains: (1) 1/2"-13 x 1 1/2" bolt, (1) washer
‡ each kit contains: (1) 1/2"-13 x 3 1/2" bolt, (1) nut, (2) washers

- Your island is packaged onto 1 pallet.
- The main pieces are labeled (alphabetically) to assist in identification and assembly.

IMPORTANT
Remove all packing material (including any protective coatings) and discard prior to use.

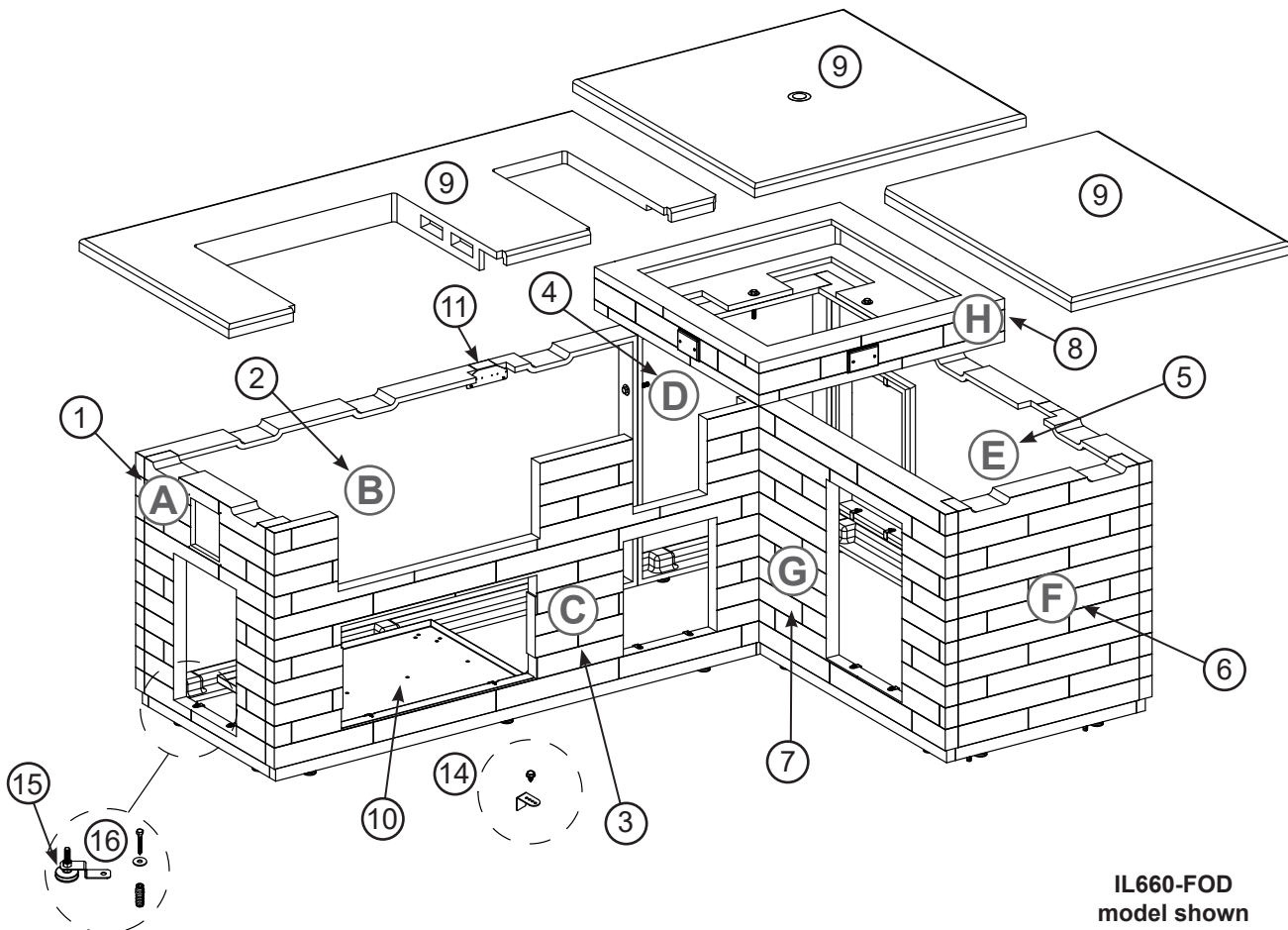

IL660-FOD
model shown

PARTS LIST (CONT.)

		IL660-(FO,SP)R
Item	Description	Qty.
1.	Side wall (A)	1
2.	Rear wall (B)	1
3.	Front wall (C)	1
4.	Rear wall (D)	1
5.	Side wall (E)	1
6.	Front wall (F)	1
7.	Side wall (G1)	1
8.	Side wall (G2)	1
9.	Top piece (H)	1
10.	Countertop (3 pieces)	1
11.	Floor pan	1
12.	Power supply box bracket (w/ Phillips screws)	1
13.	Outlet bracket *	1
14.	Duplex outlet box assy. *	3
15.	Door bracket (w/ hex screw)	16
16.	Leveler bolts	19
17.	Floor mounting brackets (w/ hardware)	5
18.	Hardware kit A * †	10
19.	Hardware kit B * ‡	6
20.	Timer box screws *	4

* not shown
† each kit contains: (1) 1/2"-13 x 1 1/2" bolt, (1) washer
‡ each kit contains: (1) 1/2"-13 x 3 1/2" bolt, (1) nut, (2) washers

- Your island is packaged onto 1 pallet.
- The main pieces are labeled (alphabetically) to assist in identification and assembly.

IMPORTANT

Remove all packing material (including any protective coatings) and discard prior to use.

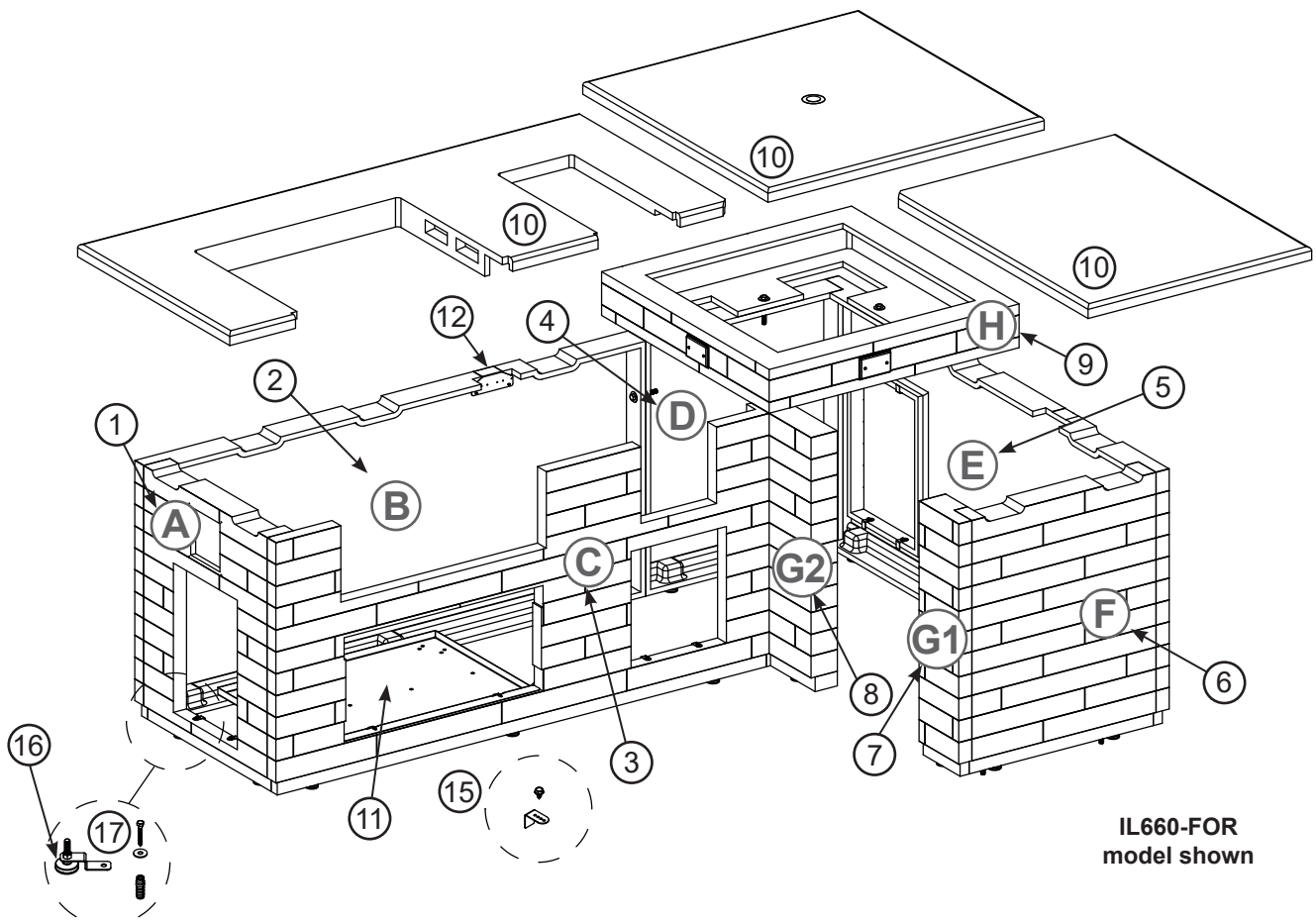

PARTS LIST (CONT.)

		IL660-(FO,SP)K
Item	Description	Qty.
1.	Side wall (A)	1
2.	Rear wall (B)	1
3.	Front wall (C)	1
4.	Rear wall (D)	1
5.	Side wall (E)	1
6.	Front wall (F)	1
7.	Side wall (G1)	1
8.	Side wall (G2)	1
9.	Top piece (H)	1
10.	Countertop (3 pieces)	1
11.	Floor pan	1
12.	Power supply box bracket (w/ Phillips screws)	1
13.	Outlet bracket *	1
14.	Duplex outlet box assy. *	3
15.	Door bracket (w/ hex screw)	16
16.	Leveler bolts	19
17.	Floor mounting brackets (w/ hardware)	5
18.	Hardware kit A * †	10
19.	Hardware kit B * ‡	6
20.	Timer box screws *	4

* not shown

† each kit contains: (1) 1/2"-13 x 1 1/2" bolt, (1) washer

‡ each kit contains: (1) 1/2"-13 x 3 1/2" bolt, (1) nut, (2) washers

- Your island is packaged onto 1 pallet.
- The main pieces are labeled (alphabetically) to assist in identification and assembly.

IMPORTANT

Remove all packing material (including any protective coatings) and discard prior to use.

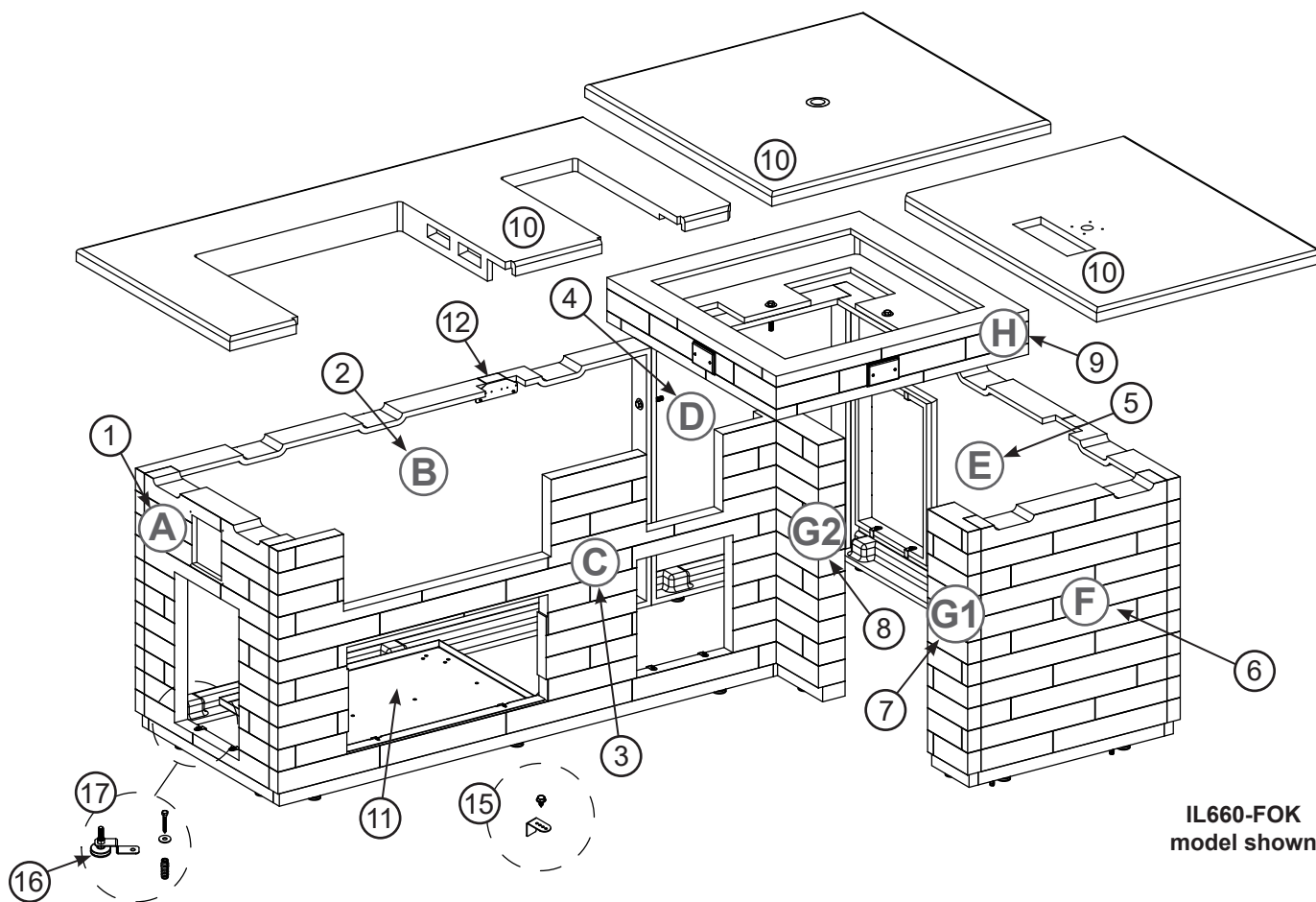

ASSEMBLY AND INSTALLATION

WARNING: Failure to position the parts in accordance with these diagrams or failure to use only parts specifically approved with this unit may result in property damage or personal injury.

TOOLS REQUIRED

- $\frac{7}{16}$ ", $\frac{1}{2}$ ", $\frac{9}{16}$ ", $\frac{3}{4}$ " open end wrenches
- Power drill with $\frac{5}{16}$ " hex driver and #2 Phillips driver
- Level
- Flathead screwdriver

LOCATION

While following all requirements and safety information in the owner's manuals included with your products, determine and prepare the location of the island (a hard and level surface).

Note: A combustible surface is permitted.

Important: The gas supply and electrical setup must be considered when determining the location of the island. Refer to all owner's manuals included with your products for details (as applicable).

**ASSEMBLY AND INSTALLATION REQUIRES TWO OR MORE PEOPLE.
EXERCISE EXTREME CARE DURING ASSEMBLY AND INSTALLATION.**

ASSEMBLY AND INSTALLATION (Cont.)

ASSEMBLY AND INSTALLATION OVERVIEW - PANTRY MODELS

CAUTION: Island components are heavy. **CAREFULLY** handle all components during assembly. **Wear gloves.**

- Fig. 8-1 provides an overall orientation and bolt assembly detail for the island with pantry.
- This section is just an overview, refer to the following step-by-step section for complete assembly (and grill/griddle/accessory/pizza oven installation) details.

ONLY **HAND TIGHTEN**
BOLTS DURING STEP 2!

LEVEL, SQUARE, AND
FULLY TIGHTEN DURING
STEP 3.

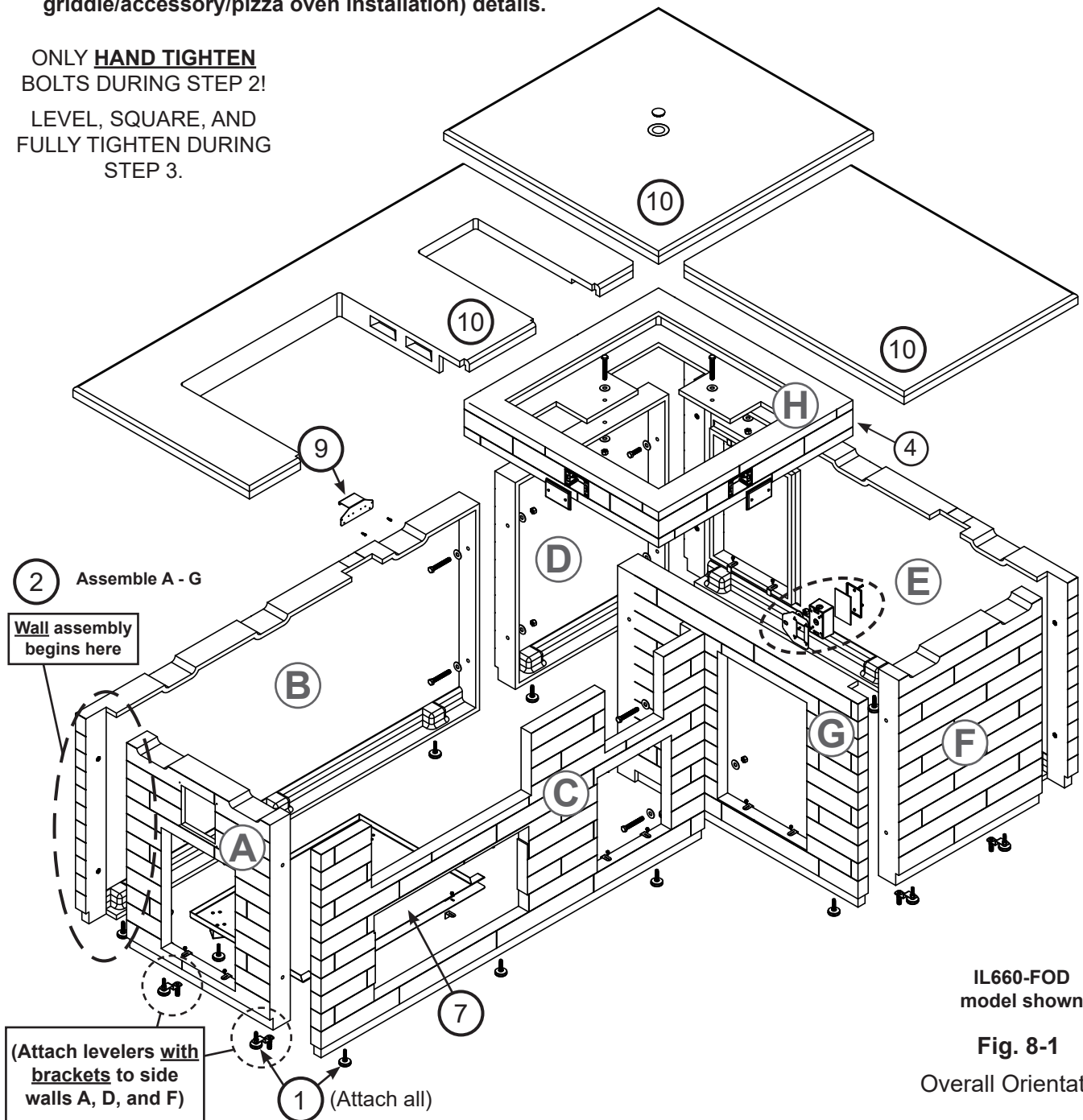

IL660-FOD
model shown

Fig. 8-1

Overall Orientation

ASSEMBLY / INSTALL OVERVIEW

- | | | |
|--|---|--|
| 1. Attach all levelers | 4. Secure island to floor * | 9. Install power supply box (only bracket shown) |
| 2. Assemble walls (A-G) | 5. Assemble top piece (H) | 10. Place countertops |
| Note: Install outlet box w/ G | 6. Install electrical * | 11. Install grill/griddle/pizza oven, double sideburner, and timer box * |
| 3. Adjust levelers to level top surfaces of unit evenly, ensure unit is square, then fully tighten all bolts * | 7. Install floor pan | |
| | 8. Install doors, drawers, and pantry * | |

* not shown

ASSEMBLY AND INSTALLATION (Cont.)

ASSEMBLY AND INSTALLATION OVERVIEW - REFRIGERATOR MODELS

CAUTION: Island components are heavy. **CAREFULLY** handle all components during assembly. **Wear gloves.**

- Fig. 9-1 provides an overall orientation and bolt assembly detail for the island with refrigerator.
- This section is just an overview, refer to the following step-by-step section for complete assembly (and grill/griddle/pizza oven accessory installation) details.

ONLY **HAND TIGHTEN**
BOLTS DURING STEP 2!

LEVEL, SQUARE, AND
FULLY TIGHTEN DURING
STEP 3.

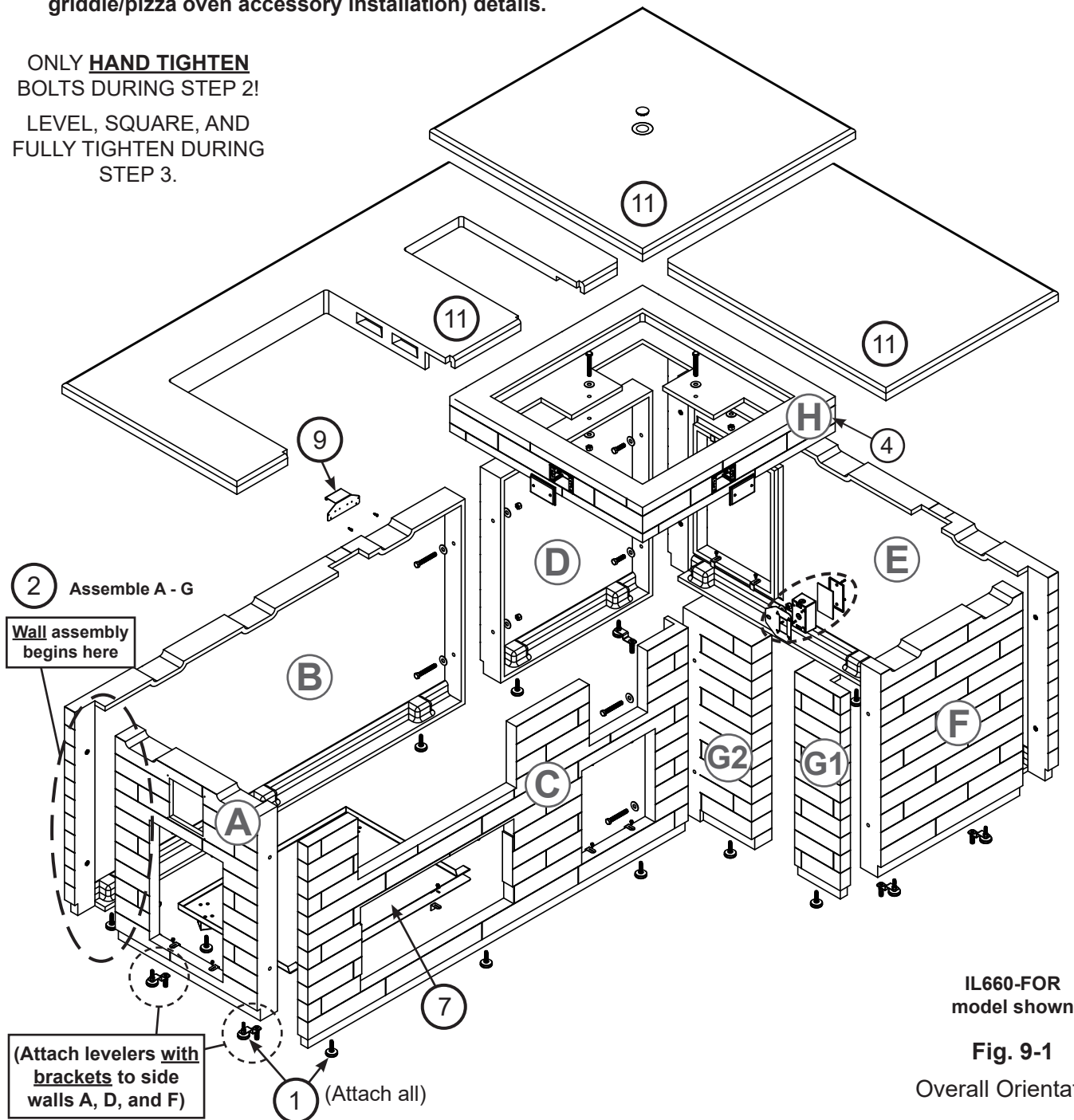

IL660-FOR
model shown

Fig. 9-1

Overall Orientation

ASSEMBLY / INSTALL OVERVIEW

- | | | |
|--|--|--|
| 1. Attach all levelers | 4. Secure island to floor * | 10. Install refrigerator * |
| 2. Assemble walls (A-G) | 5. Assemble top piece (H) | 11. Place countertops |
| Note: Install outlet box w/ G2 | 6. Install electrical * | 12. Install grill/griddle/pizza oven, double sideburner, and timer box * |
| 3. Adjust levelers to level top surfaces of unit evenly, ensure unit is square, then fully tighten all bolts * | 7. Install floor pan | |
| | 8. Install doors and drawers * | |
| | 9. Install power supply box (only bracket shown) | |

* not shown

ASSEMBLY AND INSTALLATION (Cont.)

ASSEMBLY AND INSTALLATION OVERVIEW - KEGERATOR MODELS

CAUTION: Island components are heavy. **CAREFULLY** handle all components during assembly. **Wear gloves.**

- Fig. 10-1 provides an overall orientation and bolt assembly detail for the island with kegerator.
- This section is just an overview, refer to the following step-by-step section for complete assembly (and grill/griddle/pizza oven/accessory installation) details.

ONLY **HAND TIGHTEN**
BOLTS DURING STEP 2!

LEVEL, SQUARE, AND
FULLY TIGHTEN DURING
STEP 3.

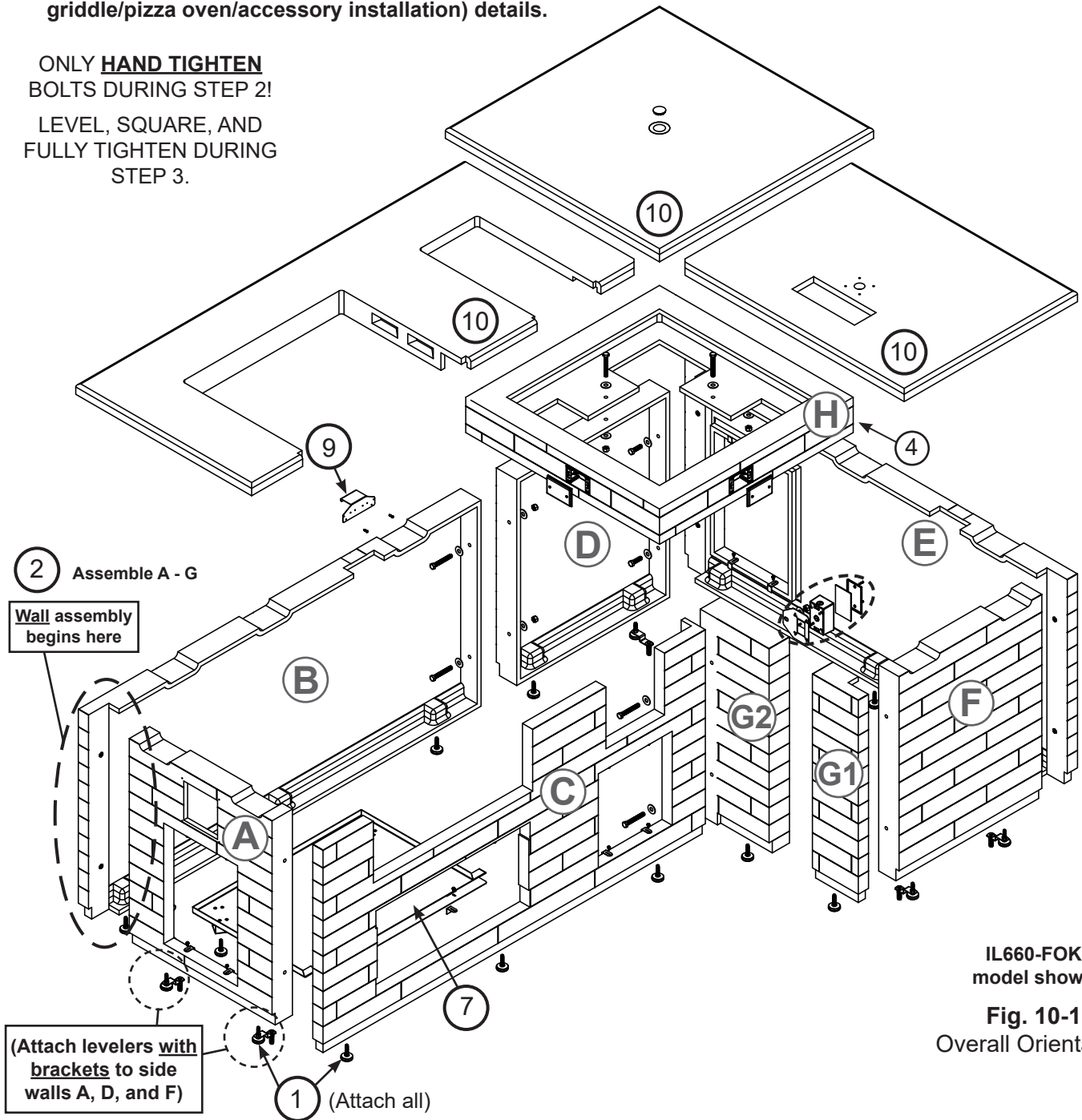

IL660-FOK
model shown

Fig. 10-1
Overall Orientation

ASSEMBLY / INSTALL OVERVIEW

- | | | |
|--|--|---|
| 1. Attach all levelers | 4. Secure island to floor * | 10. Place countertops |
| 2. Assemble walls (A-G) | 5. Assemble top piece (H) | 11. Install kegerator * |
| Note: Install outlet box w/ G2 | 6. Install electrical * | 12. Install grill/griddle/pizza oven, double sideburner and timer box * |
| 3. Adjust levelers to level top surfaces of unit evenly, ensure unit is square, then fully tighten all bolts * | 7. Install floor pan | |
| | 8. Install doors and drawers * | |
| | 9. Install power supply box (only bracket shown) | |

* not shown

ASSEMBLY AND INSTALLATION - STEP BY STEP

CAUTION: Island components are heavy. **CAREFULLY** handle all components during assembly. **Wear gloves.**

Important: **DO NOT** fully tighten any bolts until the island base is leveled and squared. Hand tighten until instructed to fully tighten.

Note: Various IL660 models are depicted here. Your assembly may slightly vary depending on model selected.

Note: The main pieces are labeled (alphabetically) to assist in identification and assembly.

Attach Levelers

1. Locate the island pieces in an appropriate location (refer back to the LOCATION section if needed).
2. Carefully lay down all pieces that make up the island base and attach the levelers (see Fig. 11-1).

Important: The levelers are required for ventilation and leveling purposes.

Assemble Side Wall (A) & Rear Wall (B)

Orient the side wall (A) and rear wall (B) as shown. Carefully align the pilot holes, and insert the hardware (hardware kit A) in the order shown. Hand tighten only. See Fig. 11-2.

Assemble Front Wall (C)

Orient the front wall (C) and repeat the hardware installation process (hardware kit A). Hand tighten only. See Fig. 11-3.

Assemble Rear Wall (D)

Orient the rear wall (D) as shown. Carefully align the pilot holes, and insert the hardware (hardware kit B) in the order shown. Hand tighten only. See Fig. 11-4.

Installation continued on next page

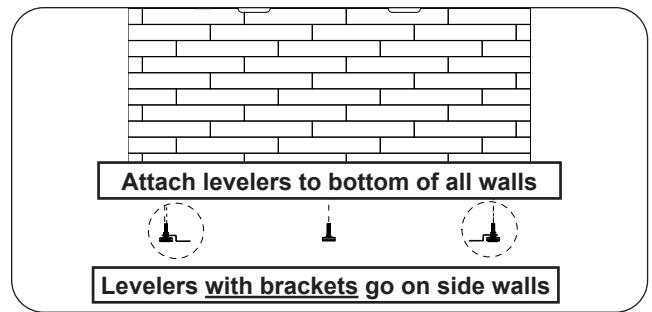

Fig. 11-1 Attach levelers

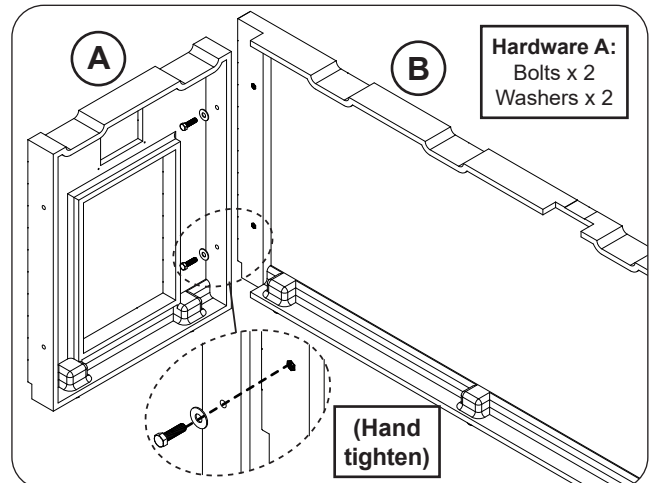

Fig. 11-2 Assemble side wall and rear wall

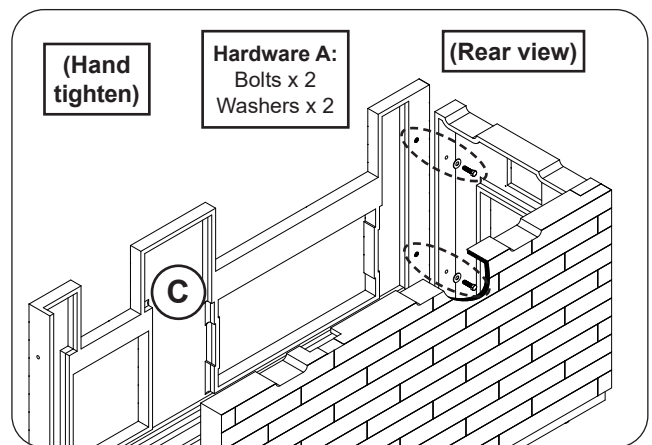

Fig. 11-3 Assemble front wall

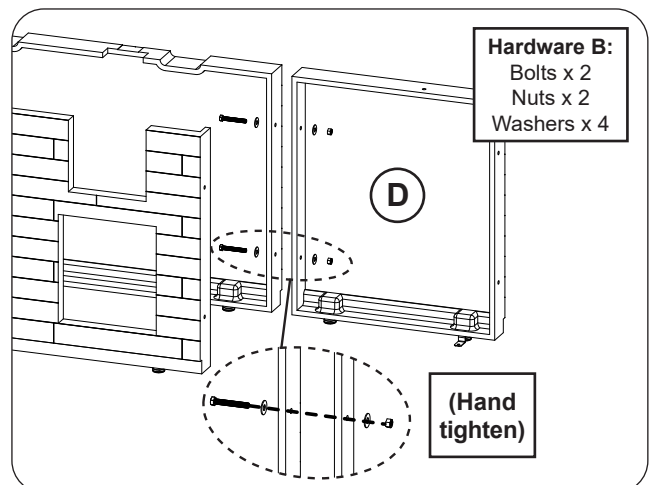

Fig. 11-4 Assemble rear wall

Assemble Side Wall (E)

Orient the side wall (E) and repeat the hardware installation process ([hardware kit A](#)). Hand tighten only. See Fig. 12-1.

Assemble Front Wall (F)

Orient the front wall (F) and repeat the hardware installation process ([hardware kit A](#)). Hand tighten only. See Fig. 12-2.

Assemble Side Wall (G or G1)

Orient the side wall (G or G1) and repeat the hardware installation process ([hardware kit A](#)). Hand tighten only. See Fig. 12-3 for your specific model.

Installation continued on next page

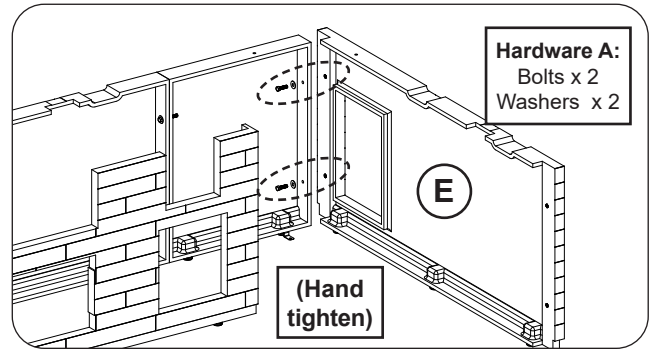

Fig. 12-1 Assemble side wall

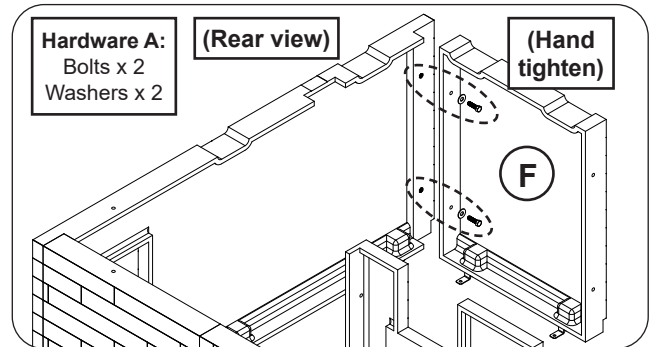

Fig. 12-2 Assemble front wall

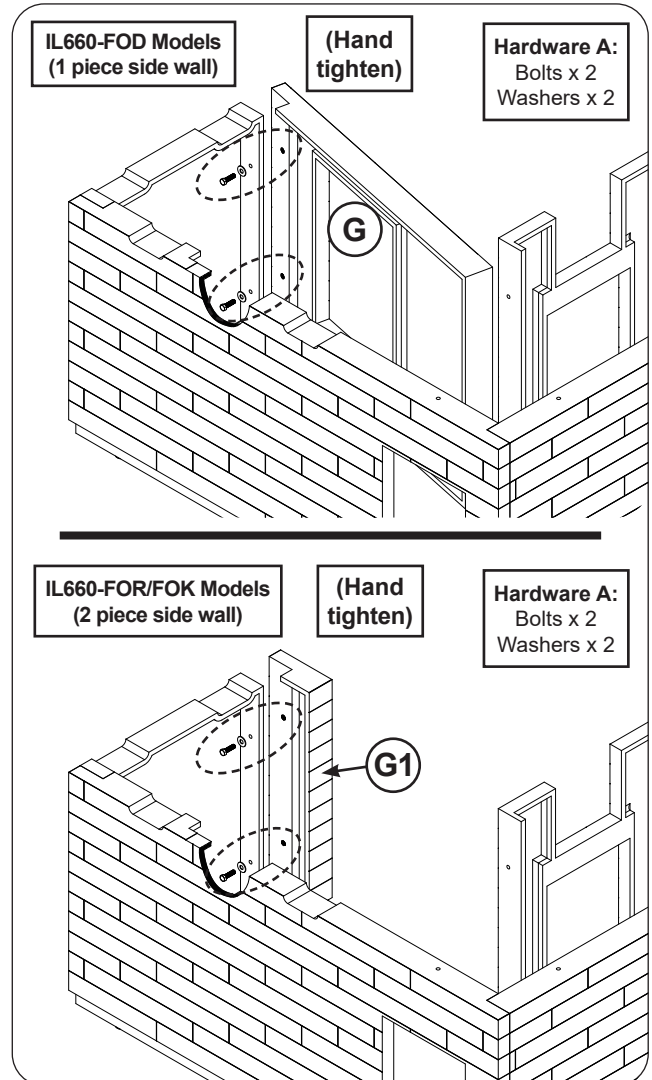

Fig. 12-3 Assemble side wall

Assemble Side Wall (G or G2) & Install Outlet Box

Orient the other end of side wall (G), OR the separate side wall (G2), and repeat the hardware installation process (hardware kit B) for the bottom hardware first. Ensure the top pilot holes are also aligned. Hand tighten only. See Fig. 13-1, step 1.

An outlet box assembly is provided and requires installation. Assemble the box as shown (using a flathead screwdriver), then repeat the hardware installation process to secure both the top of the wall and the outlet box in place. Hand tighten only. See Fig. 13-1, step 2, and Fig. 13-2.

Note: Covers are provided for any outlets that will not be used (if applicable).

Installation continued on next page

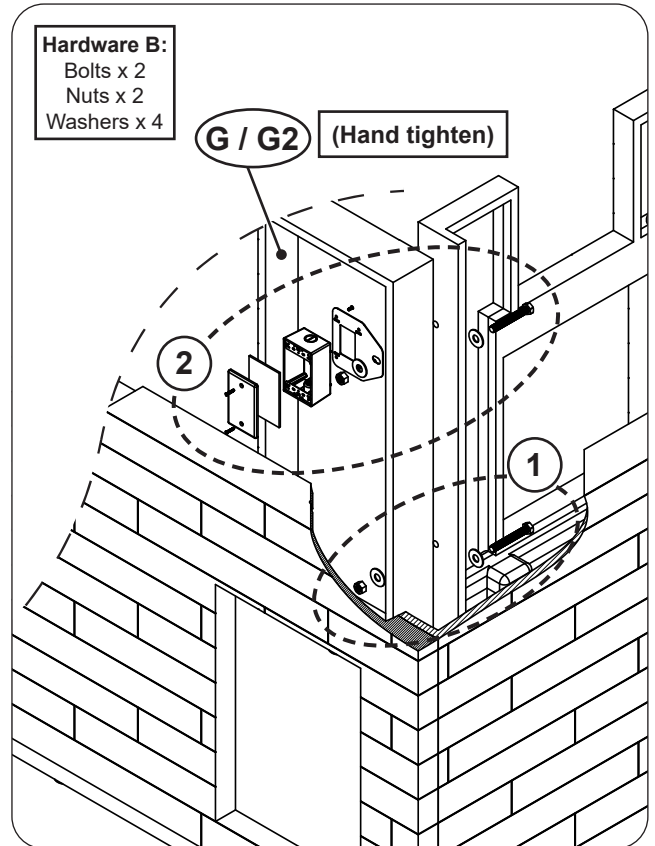

Fig. 13-1 Assemble side wall and outlet box

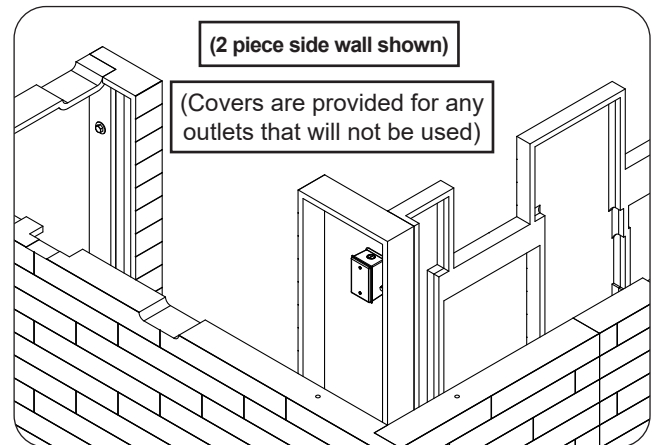

Fig. 13-2 Side wall and outlet box installed

Level, Square & Fully Tighten Island Base

1. Use the level to ensure the top surfaces of the assembly are level. The levelers at the bottom of the island may be adjusted as needed with a $\frac{1}{2}$ " open end wrench. See Fig. 14-1.
2. Check for squareness of the island.
 - a. Measure the X1 outer dimension, see Fig. 14-2. It should be approximately $111 \frac{5}{8}$ ".
 - b. Measure the Y1 outer dimension, see Fig. 14-2. Carefully adjust the walls as needed to ensure the X & Y dimensions are equal. (The final dimension may slightly vary from that mentioned in step a.)
 - c. Measure the Z1 outer dimension, see Fig. 14-2. It should be approximately 32".
 - d. Repeat this process for X2, Y2, and Z2 (see Fig. 14-3). X2 should be approximately $81 \frac{1}{2}$ ". Z2 should be approximately 32".
3. **Once the assembly is level and square, use one/two $\frac{3}{4}$ " open end wrenches (or equivalent) to fully tighten all hardware. DO NOT OVERTIGHTEN.**

Note: Tightening of the hardware may slightly alter the setup. Check once more to ensure the island is level and square, and adjust if needed.

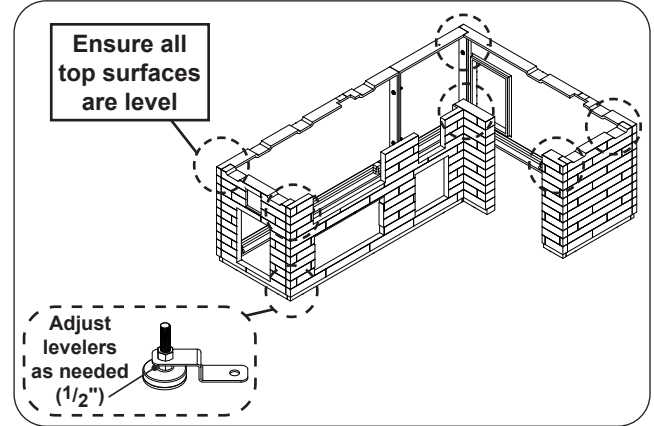

Fig. 14-1 Level assembly

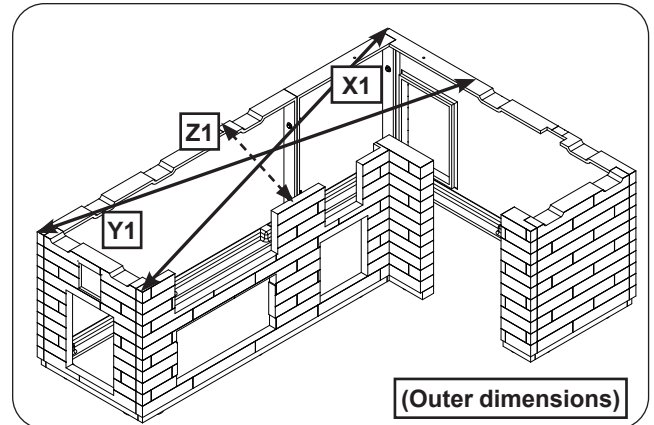

Fig. 14-2 Square unit

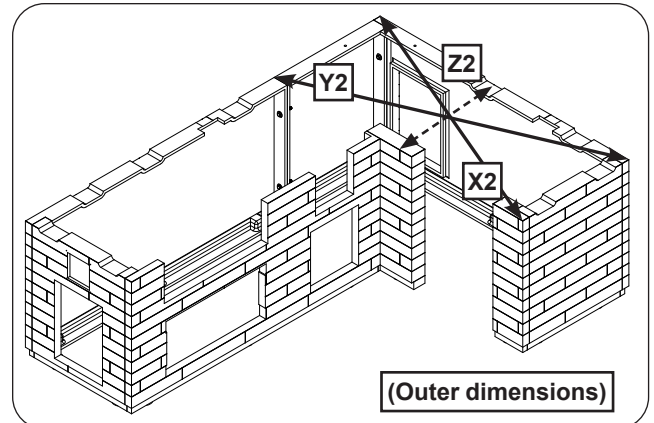

Fig. 14-3 Square unit (then tighten all bolts)

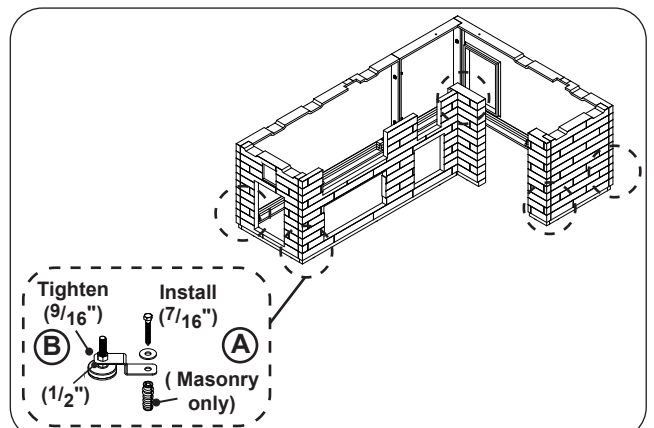

Fig. 14-4 Mount island

Secure Island to Floor

1. Secure the island to the floor using the 5 pre-installed mounting brackets. Use a $\frac{7}{16}$ " open end wrench and the supplied mounting hardware as appropriate. See Fig. 14-4, A.

Finish by tightening down the brackets. Hold a leveler in place (below bracket) with a $\frac{1}{2}$ " open end wrench, and tighten the nut (above bracket) using a $\frac{9}{16}$ " open end wrench. See Fig. 14-4, B.

Installation continued on next page

Assemble Top Piece (H)

Orient the top piece (H) and repeat the hardware installation process (hardware kit B). Fully tighten. See Fig. 15-1.

Install Electrical

Have a licensed electrician route the electrical setup for your island. Three outlet boxes are available. The primary box is located on the interior of the side wall near the double sideburner. Two additional boxes exist in the top piece. See Fig. 15-2.

Your installation may vary. **Follow all instructions included with the grill/griddle and accessories to be installed into this island.** Observe the National Electric Code and all local codes.

Install Floor Pan

1. Place floor pan into the double door cutout as shown (see Fig. 15-3).
2. Use a level to ensure the top of the pan is level. The levelers at the bottom of the pan may be adjusted as needed. The floor pan will be secured during double door installation.

Installation continued on next page

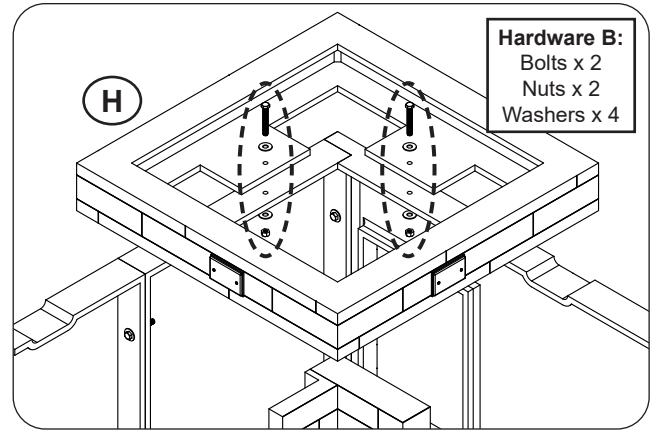

Fig. 15-1 Assemble top piece

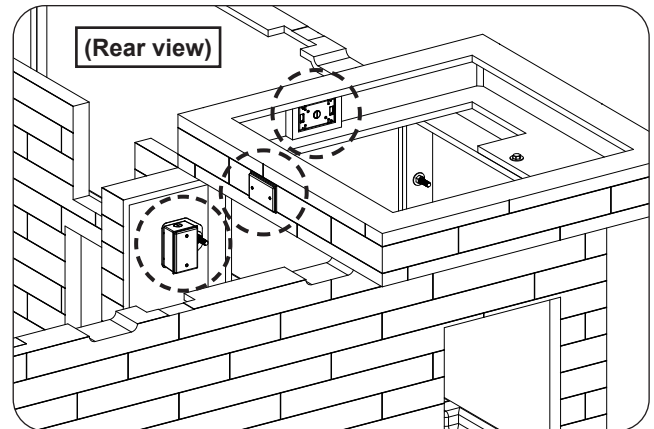

Fig. 15-2 Install electrical (as needed)

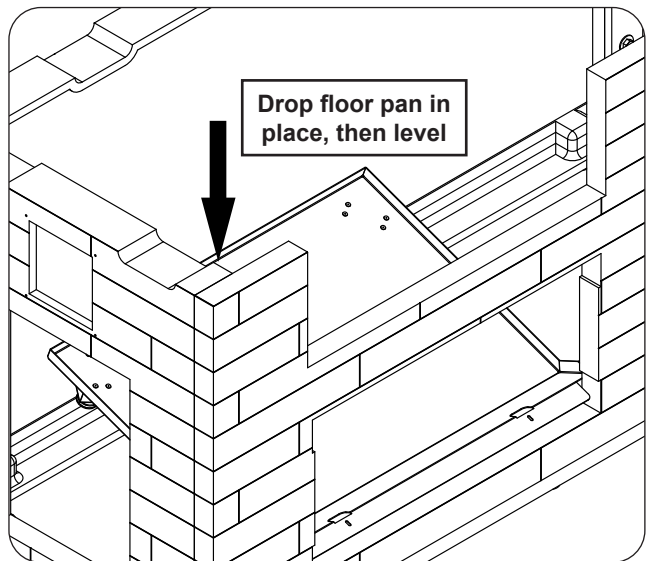

Fig. 15-3 Place floor pan

Install Drawers, Doors, and Pantry (as applicable)

The accessories for your island are purchased separately. Review the instructions provided with your accessories.

Brackets are provided for ease of installation in this island.
Follow the steps below.

1. Insert your unit completely into the appropriate opening. Ensure it is flush against the exterior wall (see Fig. 16-1, and Fig. 16-2 or Fig. 16-3, step 1).
2. The unit will have 2 oblong cutouts (or round holes) on both the top and bottom of its frame. Reach from within the island and insert a bracket where a cutout exists, **below the frame**. See Fig. 16-2 or Fig. 16-3, step 2.

Note: When installing the double door ensure the bracket is inserted **below the frame AND floor pan** (see Fig 16-3).

3. While squeezing the rear of the bracket and the front of the frame **firmly** against the concrete wall, insert a hex screw and tighten with the power drill and 5/16" hex driver (see Fig. 16-2 or Fig. 16-3, step 3). **DO NOT OVERTIGHTEN.**

Note: Certain models may require a second person to hold the bracket against the concrete wall from within the island enclosure.

4. Repeat this process for the remaining brackets and the remaining accessories in the island.

Note: Only the cutouts in the top and bottom of the frames require brackets.

Installation continued on next page

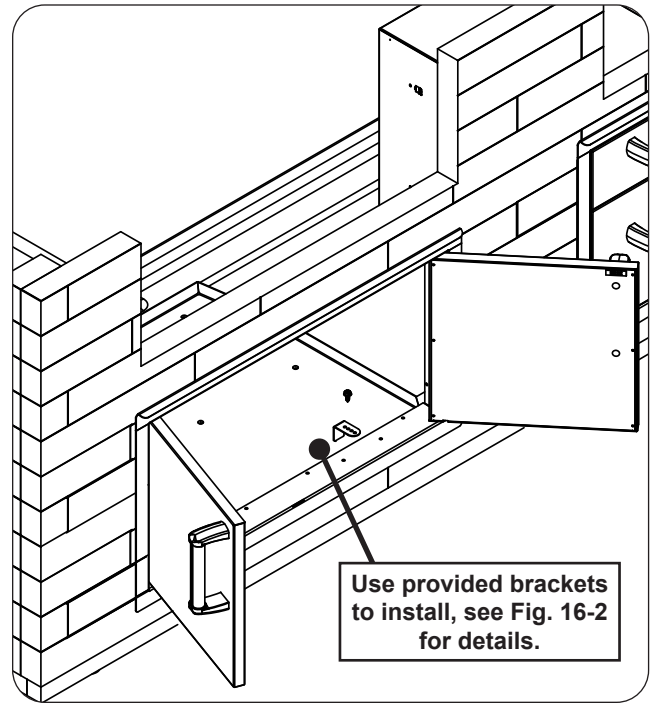

Fig. 16-1 Door/drawer/pantry install detail

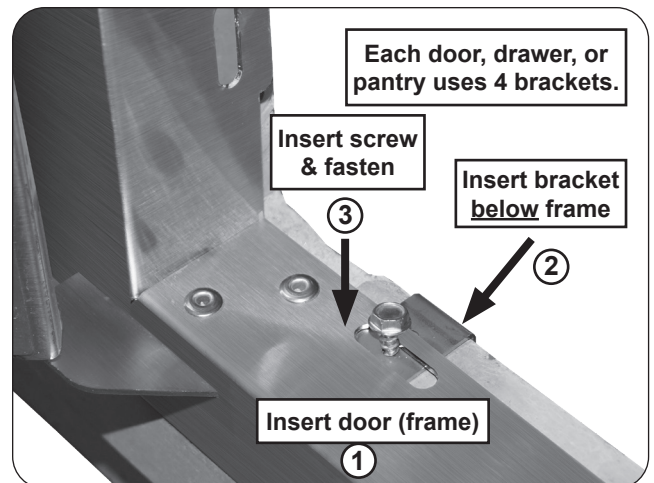

Fig. 16-2 Door/drawer/pantry install detail

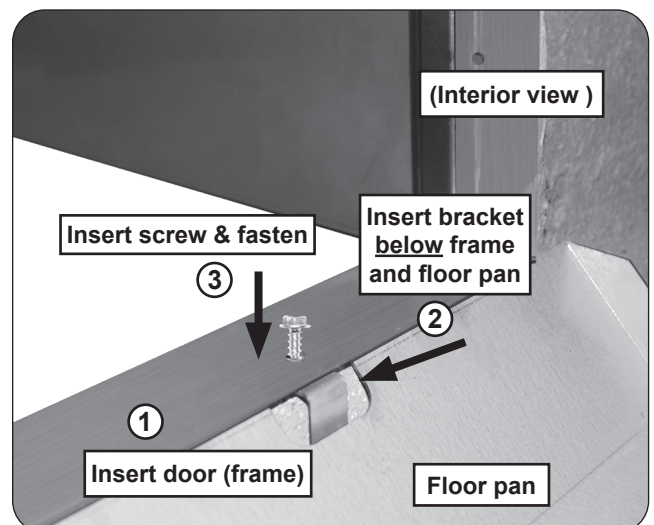

Fig. 16-3 Door/floor pan install detail

Install Power Supply Box (if applicable)

A power supply box is included with your grill/griddle and requires installation.

CAUTION: Refer to the grill/griddle owner's manual for all safety information regarding the power supply box.

A bracket is provided for installation in this island. Follow the steps below.

Note: If a pizza oven is being installed into the island, the power supply box bracket is not needed and this section can be skipped. The pizza oven control box is to be installed per the pizza oven owner's manual (at the time of pizza oven installation). Pizza oven installation is addressed later in this instruction.

1. **First** place the power supply box bracket over the rear wall, in the groove just to the left of the top piece (see Fig. 17-1).
2. Disconnect the power supply harness extension from the grill/griddle, then align the pilot holes on the power supply box with the holes on the bracket. Insert the two Phillips screws and tighten with the power drill and #2 Phillips driver (see Fig. 17-1). **DO NOT OVERTIGHTEN.**

Note: Power supply box design may vary.

Install Refrigerator (if applicable)

The refrigerator for your island is purchased separately. Refer to the instructions provided with the accessory.

In addition to all information found in the owner's manual, slide the refrigerator and plug it into the island electrical outlet (see Fig. 17-2).

Installation continued on next page

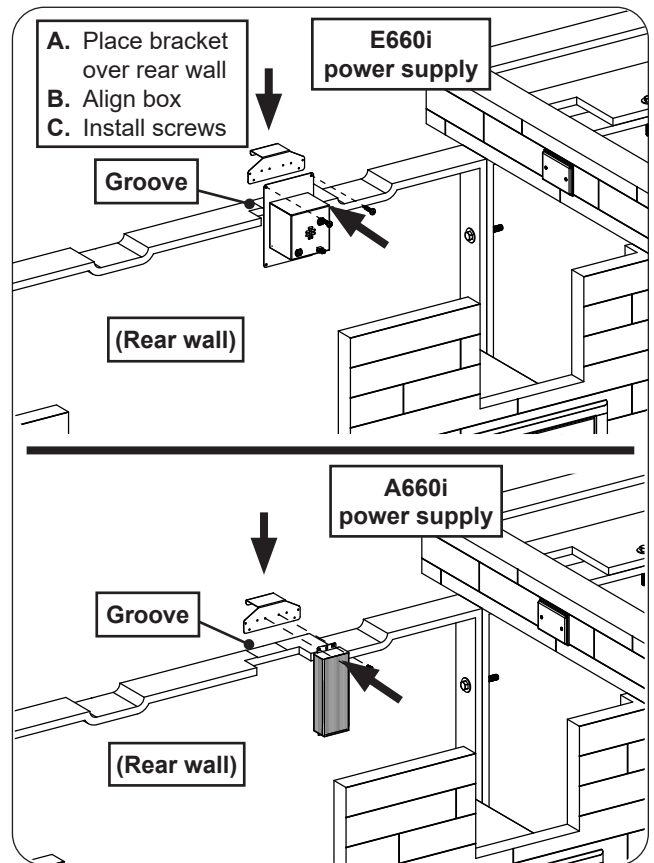

Fig. 17-1 Install power supply box

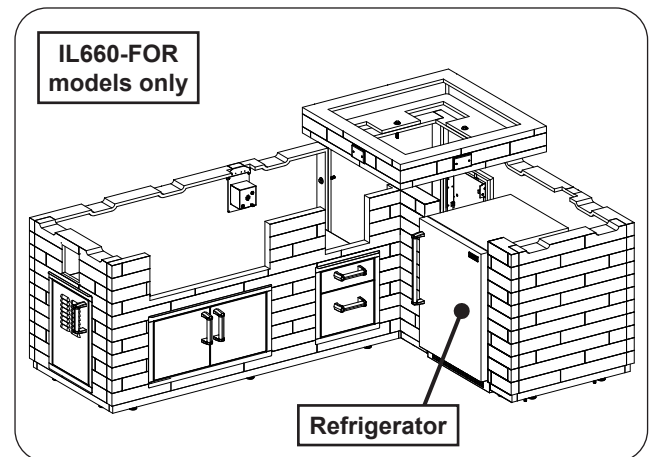

Fig. 17-2 Install refrigerator (if applicable)

Place Countertops

1. Apply silicone along the top of all 3 island sections (see Fig. 18-1, step 1).
2. Place the countertop left piece onto the island as shown in Fig. 18-1, step 2. (Be sure to align the cutouts in the countertop with the openings in the front wall.)
3. Place the countertop center piece onto the island as shown in Fig. 18-1, step 3.
4. Place the countertop right piece onto the island as shown in Fig. 18-1, step 4.

Install Kegerator (if applicable)

The kegerator for your island is purchased separately. Refer to the instructions provided with the accessory.

Note: The countertop has cutouts for the kegerator below. In addition to all information found in the owner's manual, slide the kegerator and plug it into the island electrical outlet (see Fig. 18-2).

Install Grill/Griddle/Pizza Oven, Double Sideburner, and Timer Box

The grill/griddle/pizza oven, double sideburner, and timer box for your island are purchased separately. Follow all instructions provided with your grill/griddle/pizza oven, double sideburner, and timer box for installation. See Fig. 18-3 for install locations.

Note: When installing the timer box, use the screws provided with the island.

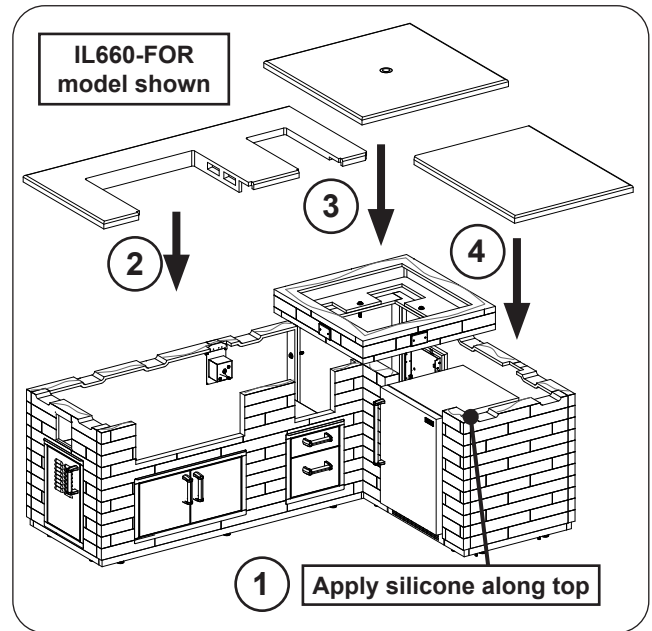

Fig. 18-1 Place countertop

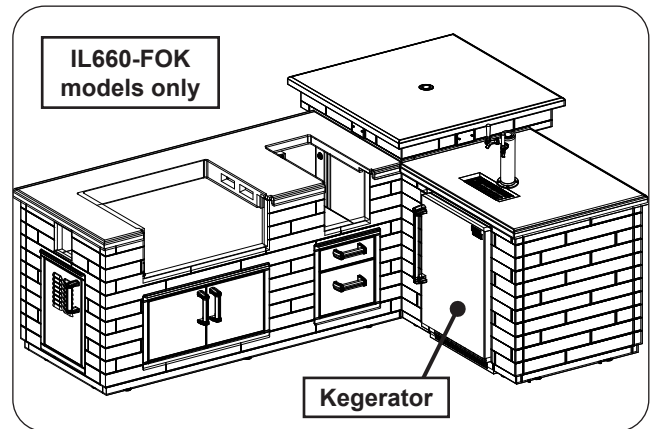

Fig. 18-2 Install kegerator (if applicable)

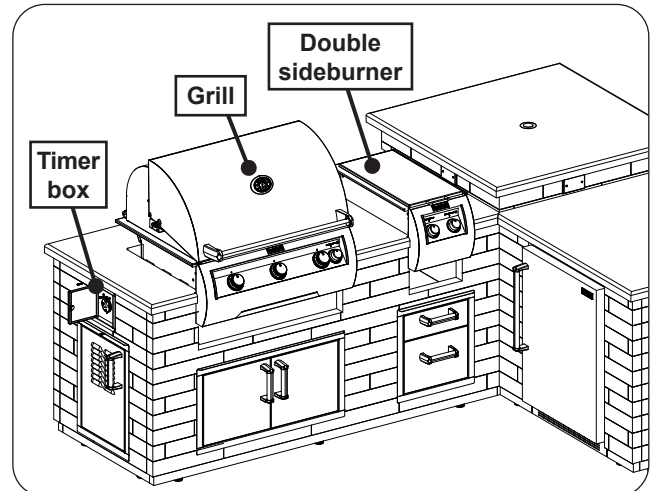

Fig. 18-3 Install grill, sideburner, and timer box

CARE AND CLEANING

- **Keep the vent openings and surrounding area of the of the island clear and free at all times.**
- For grill/griddle/pizza oven and accessory care and cleaning, refer to the owner's manuals provided with the units.

CONCRETE COMPONENTS

As with any surface, concrete components require regular maintenance and care. Certain guidelines must be followed to preserve the concrete's appearance and structural integrity.

- Use trivets to protect your countertop from high-heat.
- **Scratches may occur due to usage.** To minimize, avoid striking or dragging heavy, rough, or sharp objects across the countertop. Use a cutting board when using knives.
- **Spotting and hairline cracks may occur due to the nature of the product and are not considered a manufacturing defect.**
- **Concrete products are porous and susceptible to discoloration from liquids (especially oils and acidic substances).** During use, clean up any spills immediately to prevent any possible staining or damage to the finish. Avoid allowing water (or any liquid / substance) to stand on the surface. Using coasters for drinks is highly recommended.
- After each use, clean up any food particles or debris.
- **To clean the concrete, first wash with a mild soap and water solution. For stubborn stains, a vinyl brush may be used. Allow to dry. Annually, follow up with a masonry sealer in order to preserve the finish.**
- It should be noted that, like natural stone, concrete products will develop a patina when left outside. No two concrete products are identically the same and the finish will vary.

