

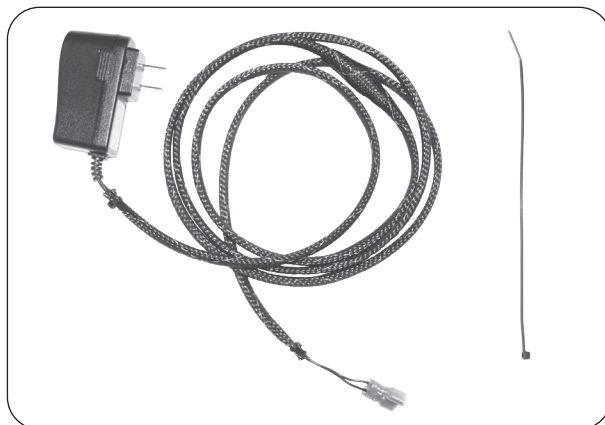

2VT POWER ADAPTER

Model# TRN-10

INSTALLER: Leave these instructions with consumer.
CONSUMER: Retain for future reference.



This power adapter is for use with Real Fyre 2VT burner systems. To install, follow the steps below.

ELECTRICAL SETUP

A 120VAC (15AMP minimum) GFCI GROUNDED 3-wire receptacle (not included) is required within the vicinity of the fireplace to provide power to the unit. Your individual installation may vary. **Observe the National Electric Code and all local codes.**

UNINSTALL BURNER SYSTEM (if applicable)

CAUTION: Ensure the appliance is OFF, completely cool, and the gas supply to the fireplace is turned off.

1. If the burner system has been previously installed, it must be completely uninstalled. Refer to the owner's manual and reverse the install.
2. Remove the burner system from the fireplace and turn it over. Then remove the batteries. See Fig. 1-1.

REMOVE CONTROL MODULE HEAT SHIELD

1. Using a $\frac{5}{16}$ " nut driver, remove the two hex screws found on the side of the control-module heat shield (see Fig. 1-2).
2. Disengage the heat shield and remove it (see Fig. 1-3).

Installation continued on next page

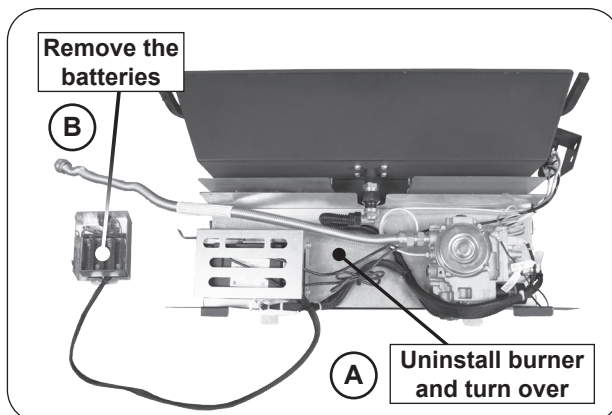

Fig. 1-1 Gain access to burner & remove batteries

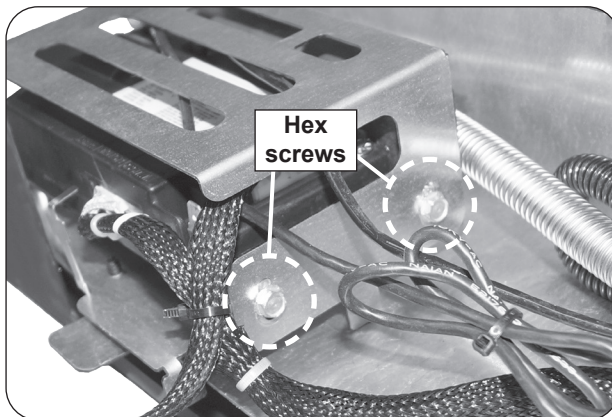

Fig. 1-2 Remove two hex screws

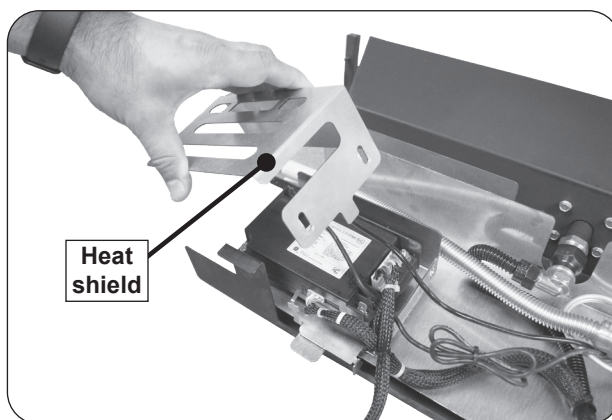

Fig. 1-3 Remove heat shield

INSTALL ADAPTER ASSEMBLY

1. Locate the two spade terminals on the control module (see Fig. 2-1), and connect the adapter-harness terminals to them (see Fig. 2-2).

Important: Ensure the harness terminals are fully inserted.

2. Zip-tie the new adapter harness to the existing wire harnesses (see Fig. 2-3).
3. Reinstall the heat shield (see Fig. 2-4).

Important: The wires and harnesses must freely exit the heat shield. Ensure they are not damaged or pinched.

INSTALL BURNER SYSTEM AND CONNECT TO POWER

1. Install the burner system per the owner's manual supplied with it. At the step to install the batteries, instead route the adapter harness out of the fireplace and to the previously wired **120VAC (15 AMP minimum) GFCI GROUNDED 3-wire receptacle** and connect.

Important: Ensure the harness is placed as far away from the burner system as possible to avoid damage.

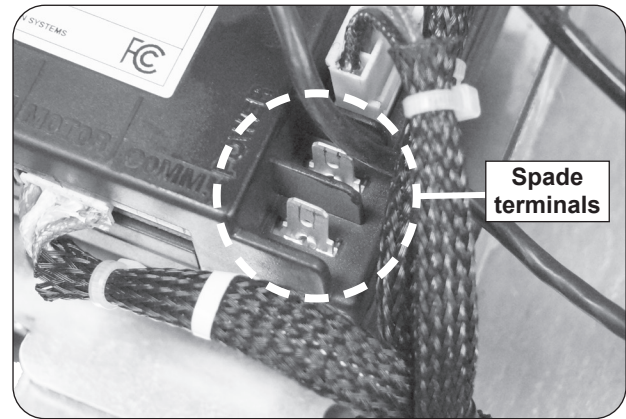

Fig. 2-1 Locate terminals on module

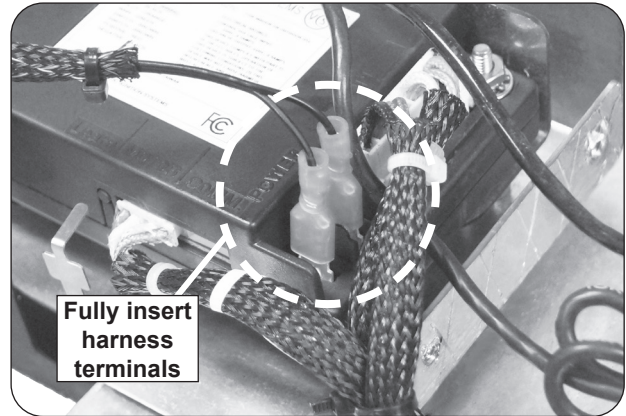

Fig. 2-2 Connect adapter harness

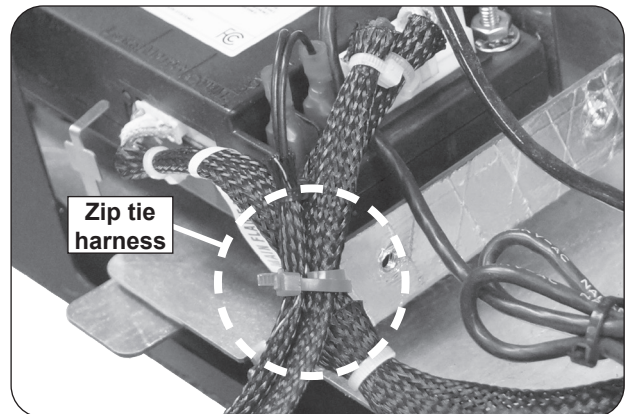

Fig. 2-3 Zip tie harness

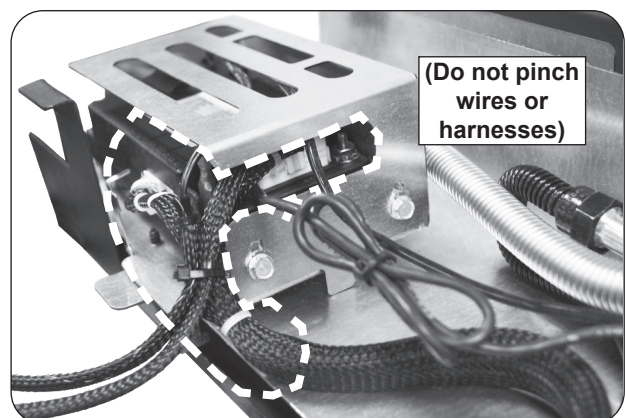

Fig. 2-4 Reinstall heat shield